

B4 DETAIL  
1" = 1'-0"

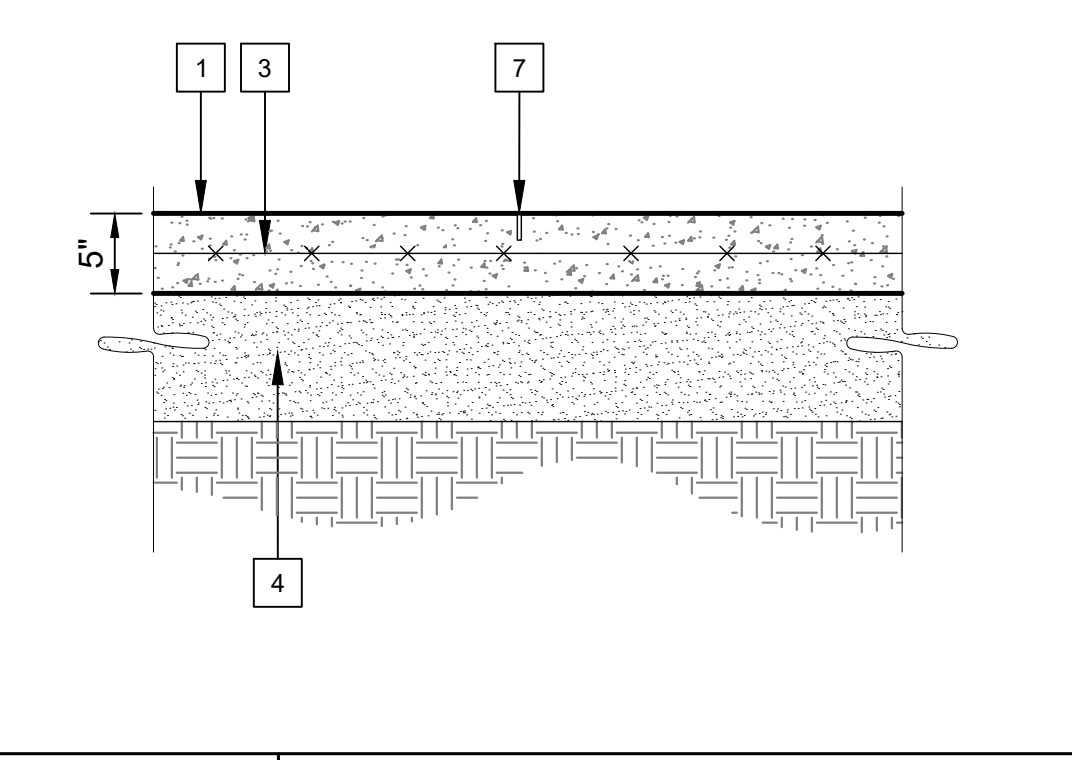

C4 DETAIL  
1" = 1'-0"

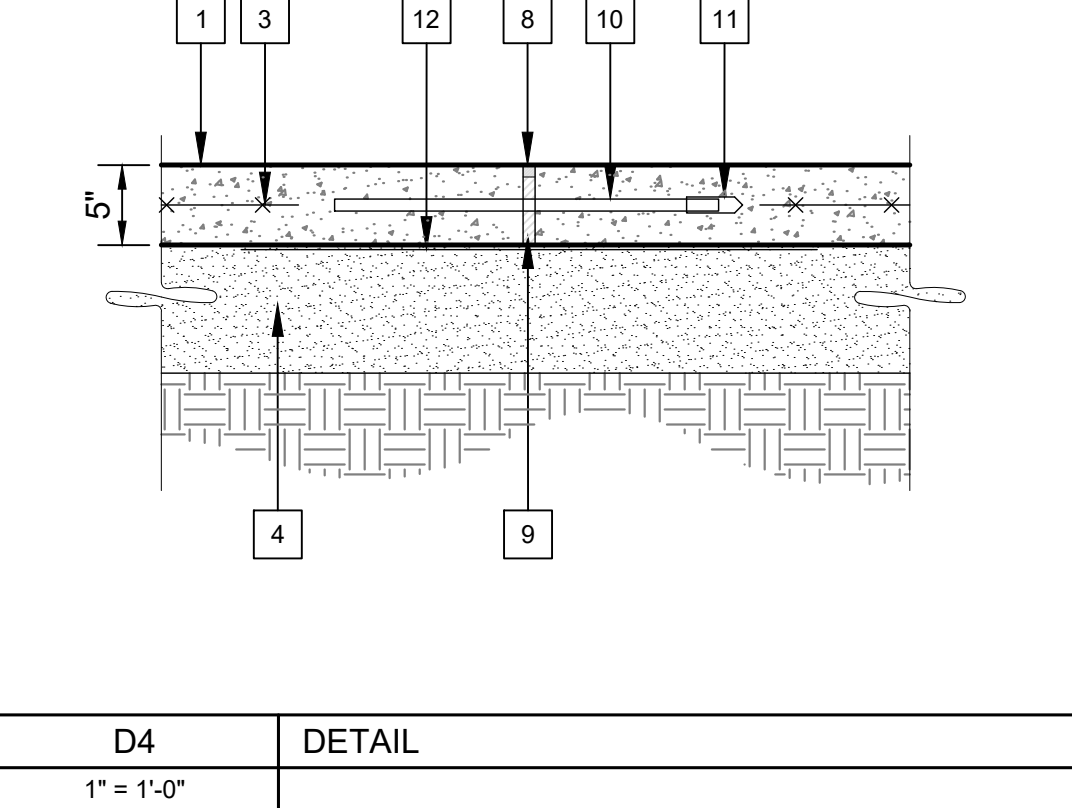

D4 DETAIL  
1" = 1'-0"



F4 DETAIL  
1" = 1'-0"

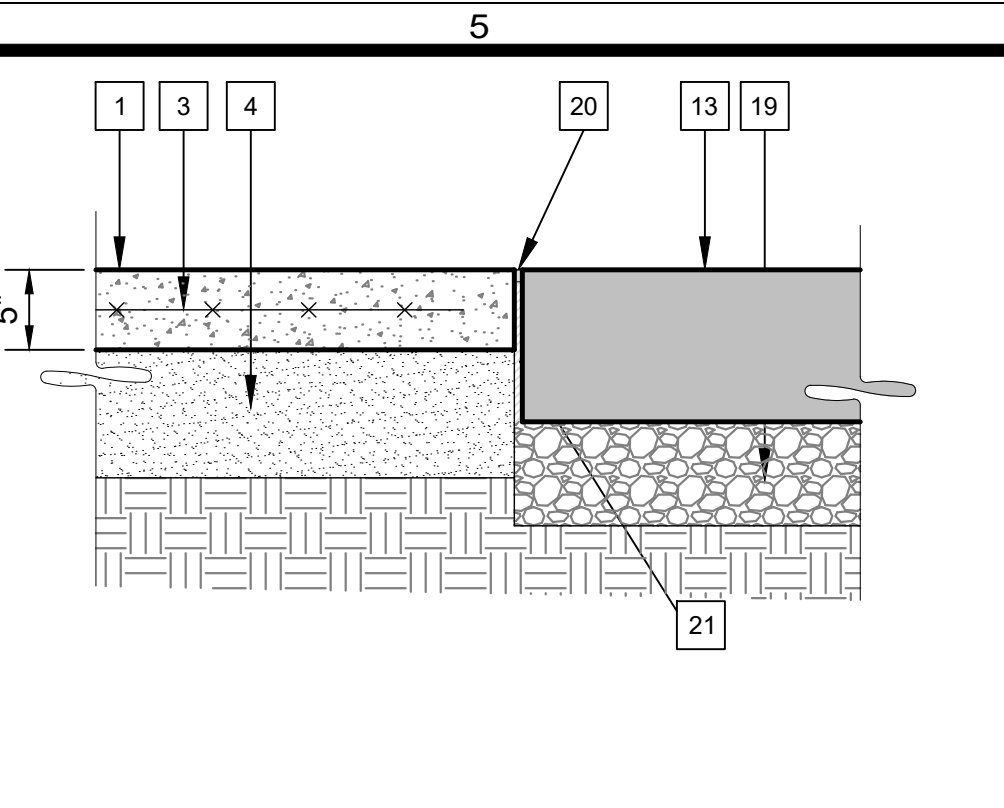

B5 DETAIL  
1" = 1'-0"

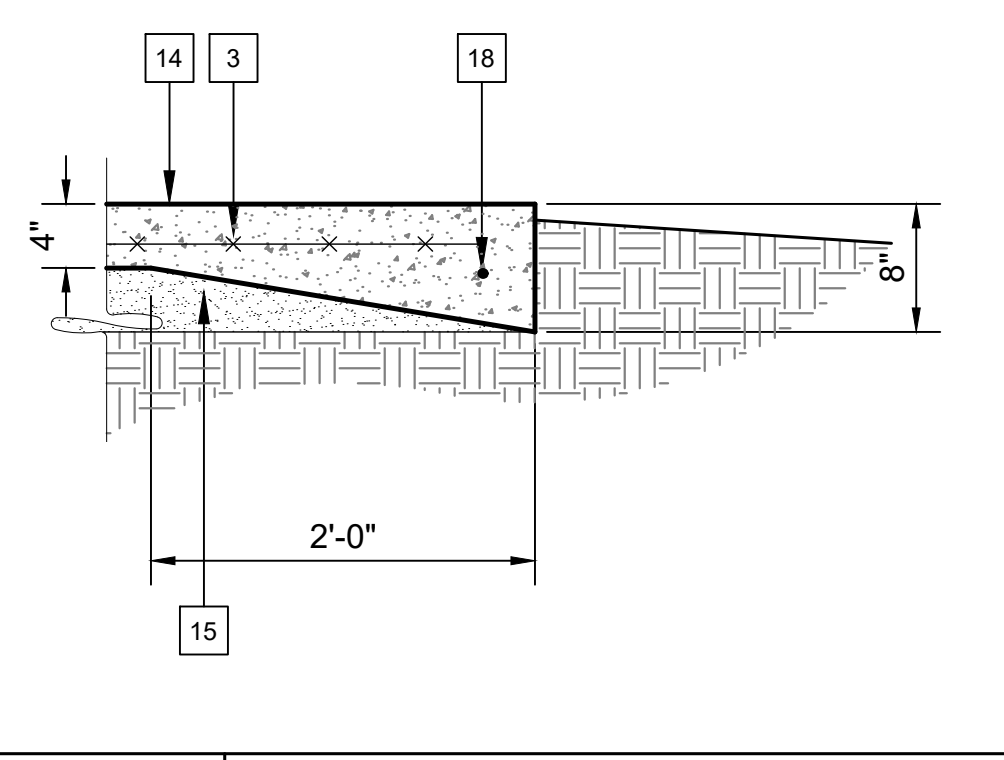

C5 DETAIL  
1" = 1'-0"

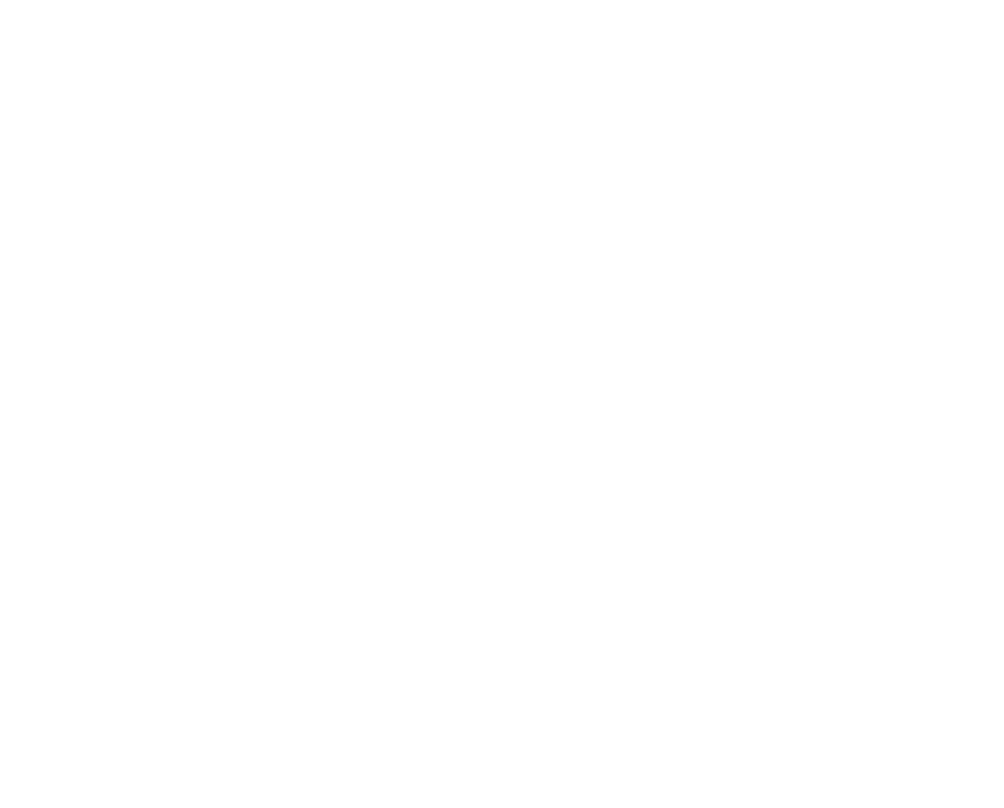

D5 DETAIL  
1" = 1'-0"



F5 DETAIL  
1" = 1'-0"

- KEYED NOTES:**
- 5" BROOM FINISH PORTLAND CEMENT CONCRETE PAVING.
  - 1/4" PRE-MOLDED JOINT FILLER (1/3 DEPTH).
  - 6 x 6 x NO. 6 WWF.
  - 8" SELECT FILL SUB-GRADE COMPACTED TO MINIMUM 95%.
  - #4 x 30" LONG AT 30" ON CENTER.
  - KEYWAY.
  - SAW CUT JOINT (1/3 DEPTH).
  - REMOVE 3/4" FILLER STRIP AND FILL WITH SEALANT.
  - EXPANSION JOINT MATERIAL.
  - 3/4" SMOOTH DOWELS x 18" LONG AT 18" ON CENTER. LUBRICATE CAP SIDE.
  - EXPANSION CAPS, ALTERNATE ENDS.
  - 36" WIDE FILTER CLOTH CENTERED ON JOINT.
  - PRE-CAST CONCRETE BASE, BY TESLA. PRE-CAST BASE SHALL MAINTAIN A CROSS SLOPE OF 1-2% AND A LONGITUDINAL SLOPE OF 0-5%.
  - 4" PORTLAND CEMENT CONCRETE SIDEWALK WITH BROOM FINISH.
  - 4" SUB-GRADE COMPACTED TO MINIMUM 95%.
  - CAST-IN-PLACE ADA COMPLIANT DETECTABLE WARNING STRIP 24" WIDE x WIDTH OF SIDEWALK. REFER TO E4 AND F4 SHEET A0.04.
  - NOTE NOT USED.
  - CONTINUOUS #4.
  - 6-1/2" MINIMUM 95% RELATIVE COMPACTED CLASS 2 AGGREGATE BASE.
  - BITUMINOUS SEALANT.
  - 1/2" EXPANSION JOINT MATERIAL.
  - SAW CUT JOINT (1/4 DEPTH F SLAB).
  - EXISTING CONCRETE PAVING.
  - SLOPE DOWN (1:12 MAX.) FROM EXISTING SIDEWALK TO DRIVEWAY ELEVATION.
  - DASHED LINES INDICATE SUPERCHARGER TO BE INSTALLED IN PHASE 2.

PROJECT NO: 26011

DRAWN: DJH

CHECKED: WAT

DATE: APRIL 2026

LAST REV:

A0.03

© 2026, Alliance Design Group, LLC all rights reserved.

Site Development for

Broadway EV Charging LLC

2501 Broadway Avenue - Alexandria, Louisiana 71302

1439 Centre Ct., Ste 401

Alexandria, LA 71301

Ph: 318.445.3151

Fx: 318.445.3988

Em: adg@adgllc.net